

1 2 3 4 5 6 7 8

A
B
C
D
E

15 CFM direction of Air Flow

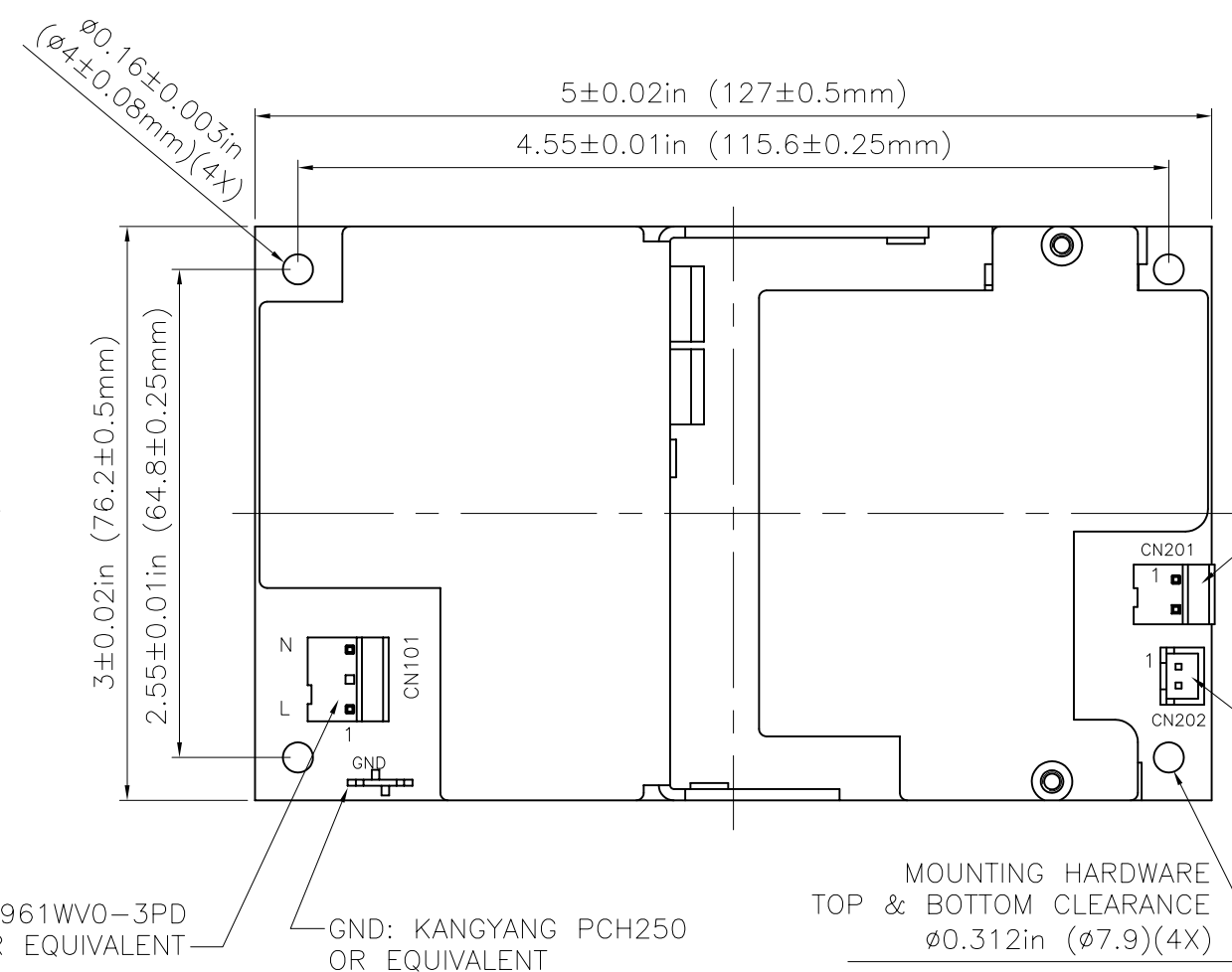
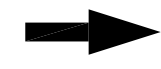

NOTES: UNLESS OTHERWISE SPECIFIED,
 1. ALL DIMENSION ARE IN mm.
 TOLERANCES TO BE $\pm 0.5 \text{ mm}$
 2. PARTS SPECIFIED AS FOLLOWS:
 2-1. CN101, CN201 SOCKET:
 MATERIAL:
 INSULATOR: NYLON 66 UL 94V-0
 CONTACT: 1.14mm SQUARE PIN, BRASS, TIN PLATED
 2-2. CN202 SOCKET:
 MATERIAL:
 INSULATOR: NYLON 66 UL 94V-0
 CONTACT: 0.64mm SQUARE PIN, BRASS, TIN PLATED

CN101	
PIN1	AC Line
PIN2	AC Neutral

CN201	
PIN1	GND
PIN2	40~58V

CN202	
PIN1	48V +Sense
PIN2	48V -Sense

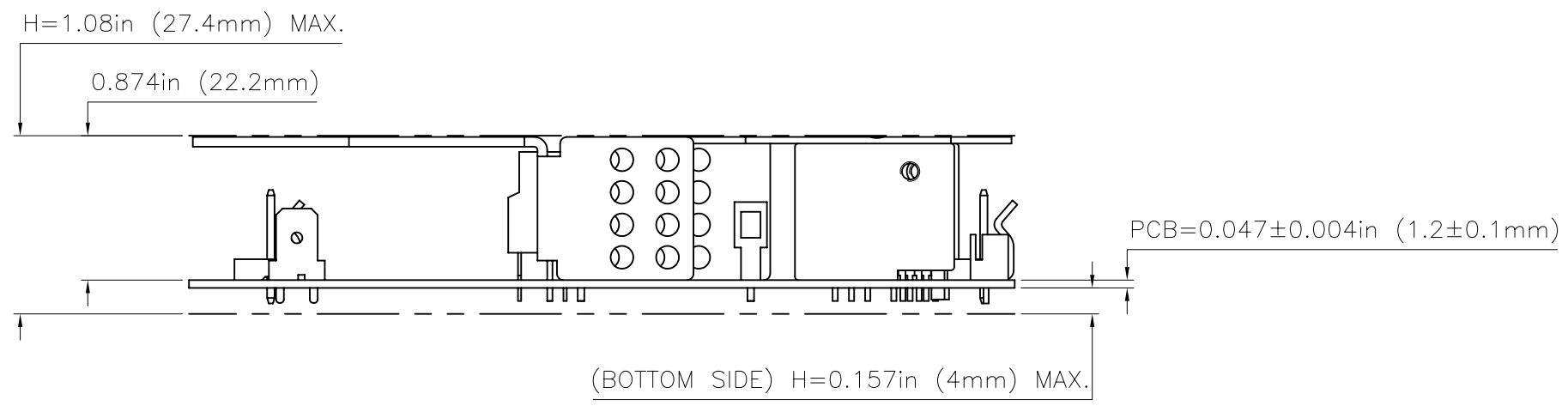

Aras Power Technologies Taiwan Branch
 美商汎瑞斯電子科技(股)公司台灣分公司

Designed	KUSH KAO	DESCRIPTION:	PART NO.:	MODEL NO.:			
Drawn	KUSH KAO	OUTLINE		ARFS-1511-4800			
Approved:		Material:	SHEET 1 OF 1	3D FILE			
DATE	May-19-2009	Treatment:	DWG NO.	ARFS1511-4800-0D	REV.	0.1	REV. DESCRIPTION DATE APP

1 2 3 4 5 6 7 8